

# Proposed Tenancy Mix

Harbour Town at Waterfront City Stage 1B  
Lease Tracking Report  
21st April 2009

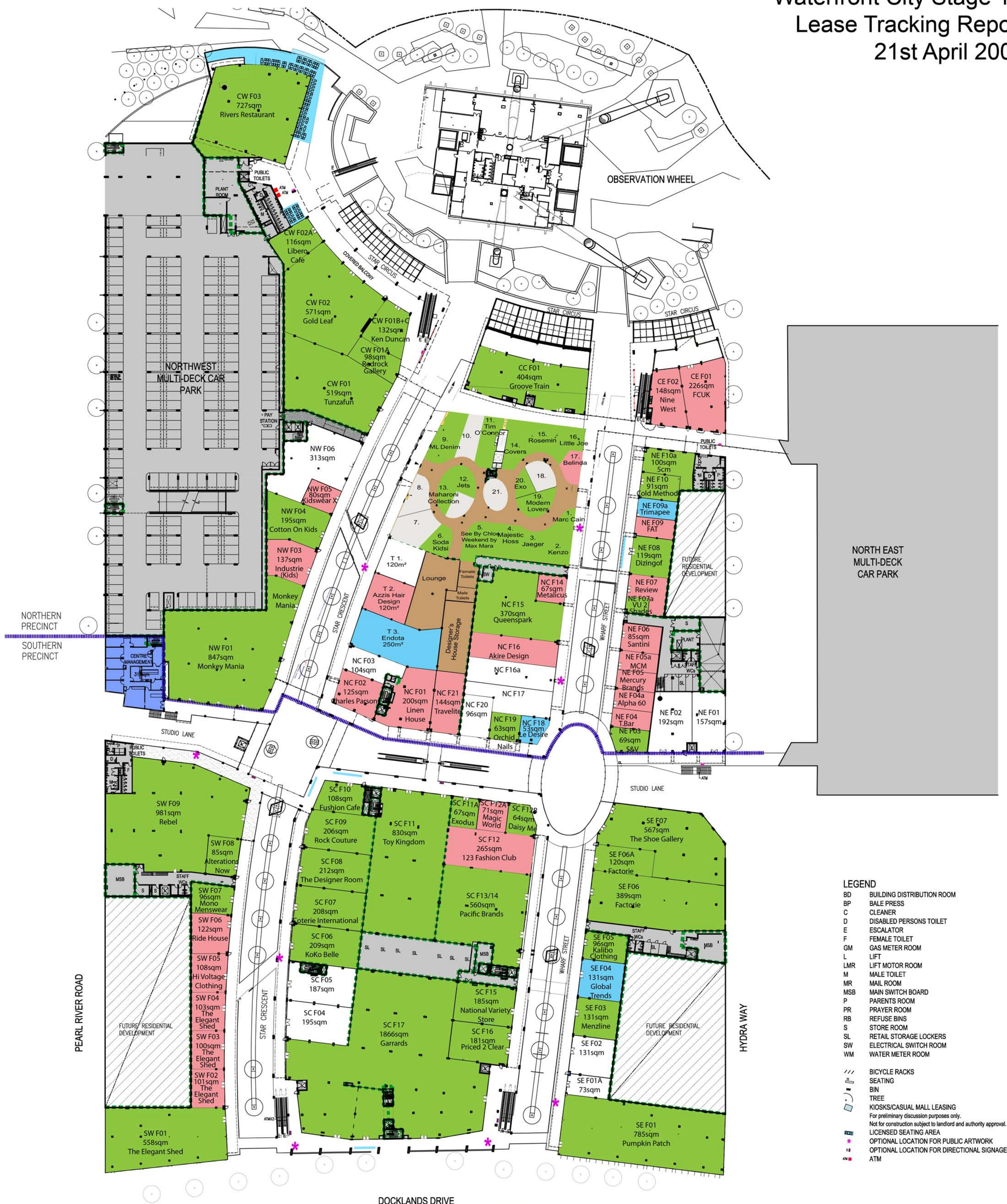

- LEGEND**
- BD BUILDING DISTRIBUTION ROOM
  - BP BALE PRESS
  - C CLEANER
  - D DISABLED PERSONS TOILET
  - E ESCALATOR
  - F FEMALE TOILET
  - GM GAS METER ROOM
  - L LIFT
  - LMR LIFT MOTOR ROOM
  - M MALE TOILET
  - MR MAIL ROOM
  - MSB MAIN SWITCH BOARD
  - P PARENTS ROOM
  - PR PRAYER ROOM
  - RB REFUSE BINS
  - S STORE ROOM
  - SL RETAIL STORAGE LOCKERS
  - SW ELECTRICAL SWITCH ROOM
  - WM WATER METER ROOM
- /// BICYCLE RACKS
  - SEATING
  - BIN
  - TREE
  - KIOSKS/CASUAL MALL LEASING
- For preliminary discussion purposes only.  
Not for construction subject to landlord and authority approval.
- LICENSED SEATING AREA
  - ★ OPTIONAL LOCATION FOR PUBLIC ARTWORK
  - ★ OPTIONAL LOCATION FOR DIRECTIONAL SIGNAGE
  - ATM

- The Designer's House
- Harbour Town Market
- SFO Issued
- SFO Signed
- Deal Approved

**PRELIMINARY**  
For discussion only  
All areas are taken from preliminary architectural drawings and are subject to final survey by a Licensed Surveyor

For preliminary discussion purpose only.  
Not for construction subject to landlord and authority approval.

Disclaimer Note: This floor plan is an indicative layout and does not represent the final tenancy mix, it is subject to change as lease negotiations progress.



Harbour Town - First level  
Retail Plan

